

4

3

2

1

THIS DRAWING IS UNPUBLISHED  
 VERTRAULICHE UNVERÖFFENTLICHTE ZEICHNUNG  
 © COPYRIGHT 2000 BY AMP INCORPORATED. ALL RIGHTS RESERVED. ALLE RECHTE VORBEHALTEN  
 RELEASED FOR PUBLICATION  
 FREI FUER VERÖFFENTLICHUNG  
 ,2000.

MATED WITH: PASSEND ZU:	LOC AI	DIST -	REVISIONS ÄNDERUNGEN			
	P	LTR	DESCRIPTION BESCHREIBUNG	DATE	DWN	APVD
PROJEKT NR.:		Y1	166500-7 superseded by 166500-2	13-MAR-01	Abr	T.M.
		Y2	Dim. 2.03 changed to (2.03)Ref. Dim. 1.68 changed to (1.68)Ref.	01-AUG-06	Abr	Brun

NOTES:

- ① UNDERCOATING: 0,8µm NICKEL OVERALL.  
CONTACT AREA: 0,8µm GOLD.  
CRIMP AREA : GOLDFLASH
- ② UNDERCOATING: 0,8µm NICKEL OVERALL.  
CONTACT AREA: 1,25µm GOLD.  
CRIMP AREA : GOLDFLASH
- ③ SUITABLE FOR 0,64x0,64 POST.
- ④ UNDERCOATING: 0,8µm NICKEL OVERALL.  
CONTACT AREA: 0,4µm GOLD.  
CRIMP AREA : GOLDFLASH
- ⑤ ADVANCED PROD. NRS. FOR DIN 41612 PART 5 SPEC.
- ⑥ PLATING : 2,0 µm TIN OVERALL.
- ⑦ REVERSE REELED FOR USE WITH MINI APPLICATOR.
- ⑧ STANDARD REELED FOR USE WITH STANDARD APPLICATOR.

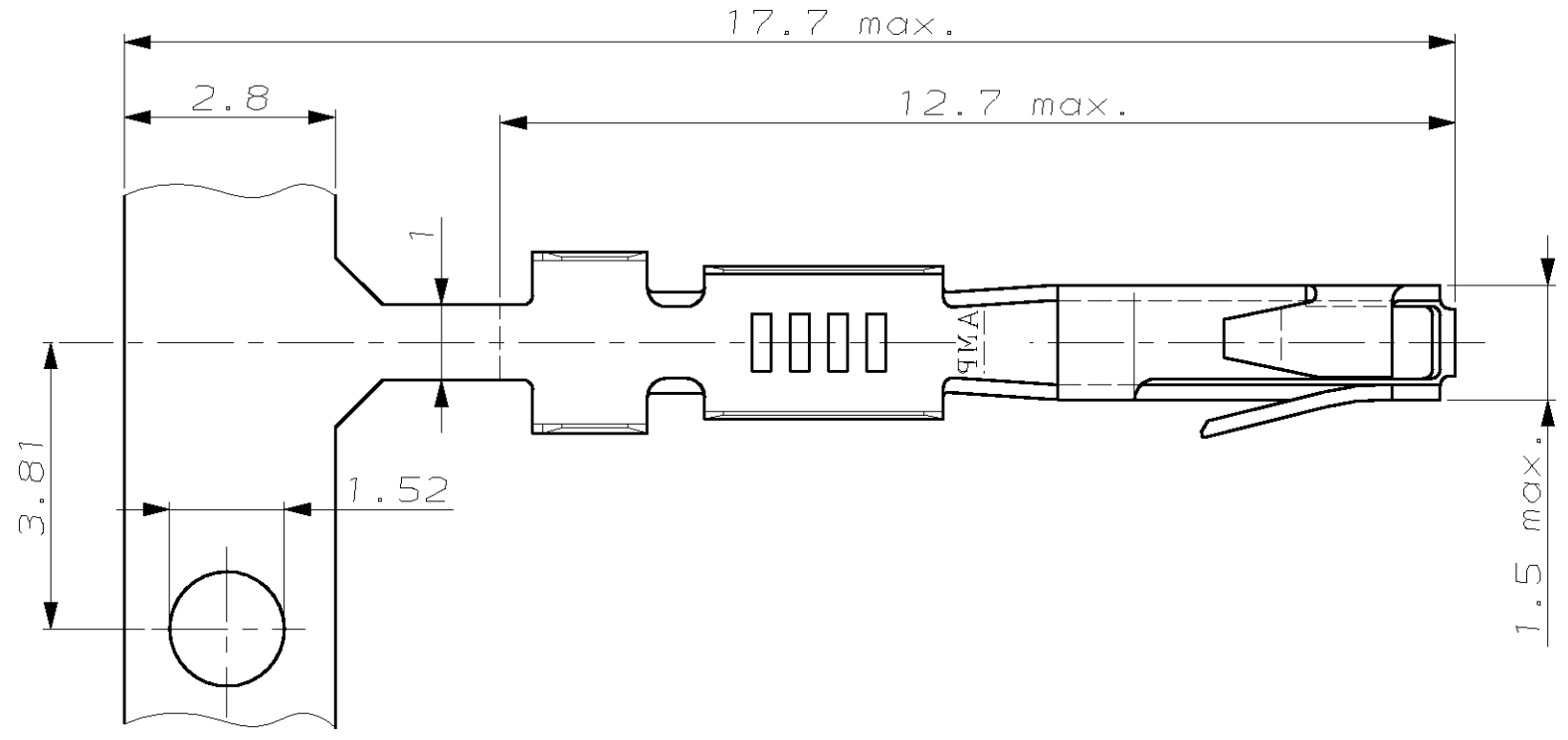
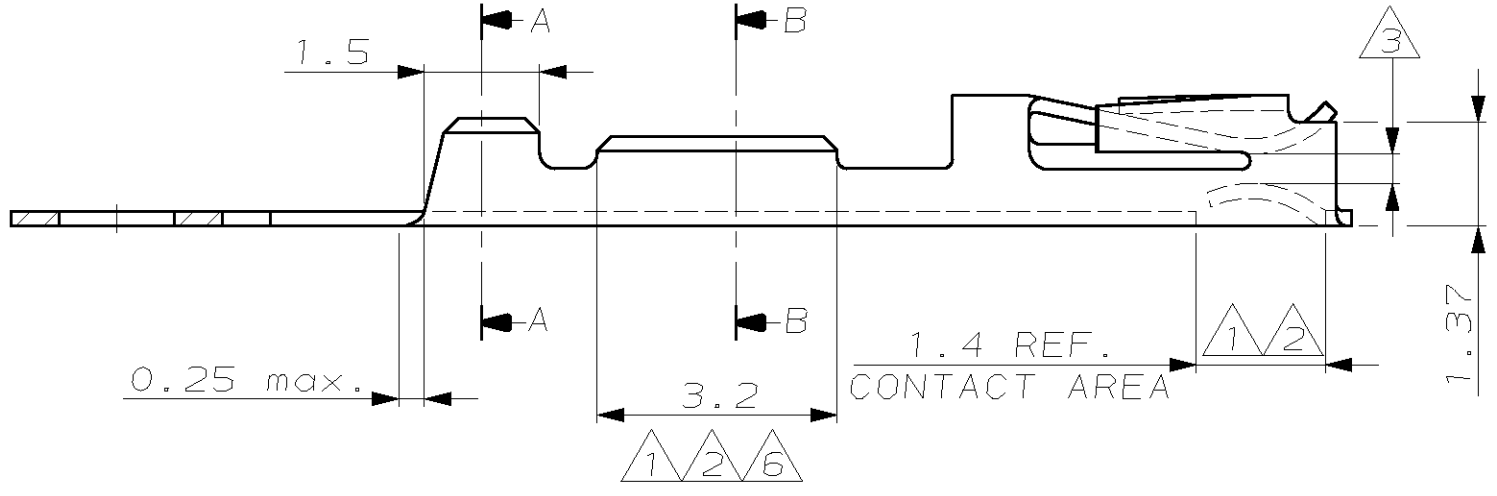

WIRE RANGE :  
20 - 24 (26) AWG  
INSULATION RANGE :  
1,40 MAX DIA.

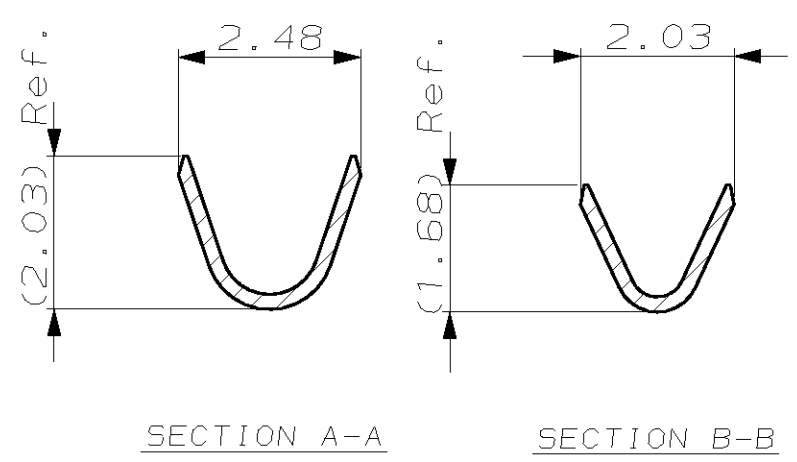

(Y1)	166722-1	①	1-166500-2	⑩
	166722-6	⑧	166500-9	⑨
SUPERSEDED BY 166500-2	⑦ 166722-4	⑥	166500-7	⑨
	166722-2	②	166500-4	⑨
	166722-1	①	166500-2	⑨
	LOOSE PIECE NUMBER	PLATING	MATERIAL	STRIPNUMBER

THIS DRAWING IS A CONTROLLED DOCUMENT FOR AMP INCORPORATED. IT IS SUBJECT TO CHANGE AND THE CONTROLLING ENGINEERING ORGANIZATION SHOULD BE CONTACTED FOR THE LATEST REVISION. DIESES ZEICHNUNGSDOKUMENT WIRD DURCH AMP INCORPORATED KONTROLLIERT. ÄNDERUNGEN, DIE DEM TECHNISCHEN FORTSCHRITT DIENEN, SIND VORBEHALTEN. DEN JEWEILS LETZTIGÜLTIGEN ÄNDERUNGSSTAND ERFAHREN SIE AUF ANFRAGE.		DWN 18-JUL-00 M. Pfeilschifter CHK 18-JUL-00 V. Huhn		<b>AMP</b> tyco Electronics AMP GmbH D - 64625 Bensheim	
DIMENSIONS: DIMENSIONEN: mm		TOLERANCES UNLESS OTHERWISE SPECIFIED, ALLGEMEINTOLERANZEN n. 150 8015 n. 150 2768 - mh		STANDARD TANDEM SPRING RECEPTACLE	
MATERIAL -		ANGLES /WINKEL ±1° FINISH /OBERFLÄCHE/FARBE -		SIZE CAGE CODE DRAWING NO ZEICHNUNGS-NR. A3 00779 C-166500	
CUSTOMER DRAWING /KUNDENZEICHNUNG		MASSSTAB 10:1		RESTRICTED TO NUR FUER -	
		BLATT 1 OF 1 VON 1		REV Y2	